

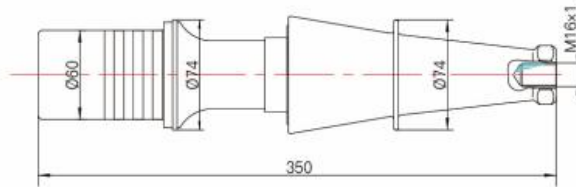

XT-6015-6D

功率 Power (W)	频率范围 Frequency range (kHz)	电阻范围 Resistance range (Ω)	晶片颜色及电容范围 (pf) Capacitor range			换能器形状 Transducer shape	变幅杆材料 Material of booster
			黄片 yellow ceramic	灰片 grey ceramic	黑片 black ceramic		
3600	14.70-14.90	< 20	19000-20500	—	23000-25000	倒喇叭型 Inverted horn	钢 Steel



XT-3828-4ZH

功率 Power (W)	频率范围 Frequency range (kHz)	电阻范围 Resistance range (Ω)	晶片颜色及电容范围 (pf) Capacitor range			换能器形状 Transducer shape	变幅杆材料 Material of booster
			黄片 yellow ceramic	灰片 grey ceramic	黑片 black ceramic		
800	27.50-28.10	< 30	7200-8200	—	10000-12000	柱型 Type column	钢 Steel



XT-3828-4ZL

功率 Power (W)	频率范围 Frequency range (kHz)	电阻范围 Resistance range (Ω)	晶片颜色及电容范围 (pf) Capacitor range			换能器形状 Transducer shape	变幅杆材料 Material of booster
			黄片 yellow ceramic	灰片 grey ceramic	黑片 black ceramic		
800	27.50-28.10	< 30	7200-8200	—	10000-12000	柱型 Type column	铝 AL





XT-3828-2ZL

功率 Power	频率范围 Frequency range	电阻范围 Resistance range	晶片颜色及电容范围 (pf) Capacitor range			换能器形状 Transducer shape	变幅杆材料 Material of booster
			黄片 yellow ceramic	灰片 grey ceramic	黑片 black ceramic		
(W)	(kHz)	(Ω)				柱型 Type column	铝 AL
500	27.50-28.10	<40	3700-4200	—	—		

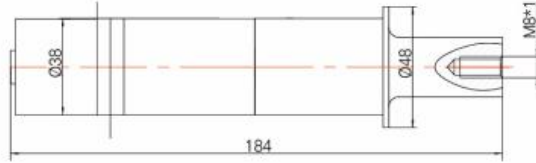

XT-3030-4

功率 Power	频率范围 Frequency range	电阻范围 Resistance range	晶片颜色及电容范围 (pf) Capacitor range			换能器形状 Transducer shape	变幅杆材料 Material of booster
			黄片 yellow ceramic	灰片 grey ceramic	黑片 black ceramic		
(W)	(kHz)	(Ω)				柱型 Type column	铝 AL
700	29.50-30.10	<40	—	6200-7200	—		

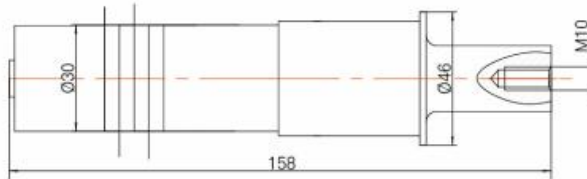

XT-3035-4ZL

功率 Power	频率范围 Frequency range	电阻范围 Resistance range	晶片颜色及电容范围 (pf) Capacitor range			换能器形状 Transducer shape	变幅杆材料 Material of booster
			黄片 yellow ceramic	灰片 grey ceramic	黑片 black ceramic		
(W)	(kHz)	(Ω)				柱型 Type column	钢 Steel
700	34.50-35.10	<40	5500-6200	—	—		

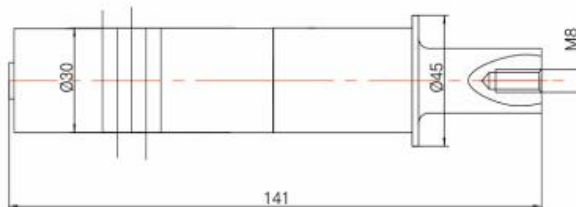



XT-3535-4D-II

功率 Power (W)	频率范围 Frequency range (kHz)	电阻范围 Resistance range (Ω)	晶片颜色及电容范围 (pf) Capacitor range			换能器形状 Transducer shape	变幅杆材料 Material of booster
			黄片 yellow ceramic	灰片 grey ceramic	黑片 black ceramic		
800	34.50-35.10	< 35	6600-7400	—	9200-10200	倒喇叭型 Inverted horn	钢 Steel

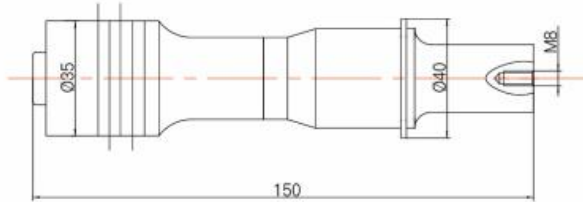

XT-3030-4HH

功率 Power (W)	频率范围 Frequency range (kHz)	电阻范围 Resistance range (Ω)	晶片颜色及电容范围 (pf) Capacitor range			换能器形状 Transducer shape	变幅杆材料 Material of booster
			黄片 yellow ceramic	灰片 grey ceramic	黑片 black ceramic		
700	29.50-30.10	< 40	—	6200-7200	—	柱型 Type column	钢 Steel

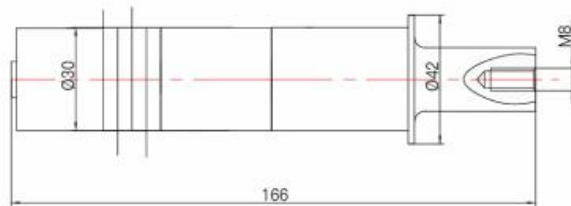

XT-3030-4KZ

功率 Power (W)	频率范围 Frequency range (kHz)	电阻范围 Resistance range (Ω)	晶片颜色及电容范围 (pf) Capacitor range			换能器形状 Transducer shape	变幅杆材料 Material of booster
			黄片 yellow ceramic	灰片 grey ceramic	黑片 black ceramic		
700	29.50-30.10	< 40	—	6200-7200	—	柱型 Type column	铝 AL

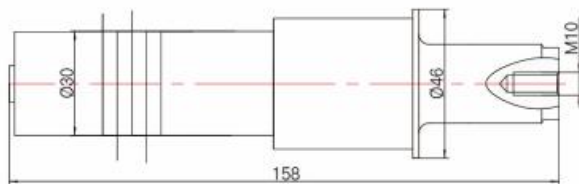



XT-5020-4HZ

功率 Power	频率范围 Frequency range	电阻范围 Resistance range	晶片颜色及电容范围 (pf) Capacitor range			换能器形状 Transducer shape	变幅杆材料 Material of booster
(W)	(kHz)	(Ω)	黄片 yellow ceramic	灰片 grey ceramic	黑片 black ceramic	柱型 Type column	钢 Steel
1500	19.70-20.00	< 20	—	—	11000-12000		

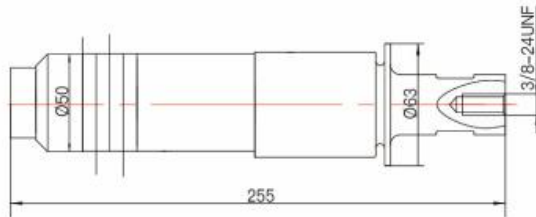

XT-7015-4D

功率 Power	频率范围 Frequency range	电阻范围 Resistance range	晶片颜色及电容范围 (pf) Capacitor range			换能器形状 Transducer shape	变幅杆材料 Material of booster
(W)	(kHz)	(Ω)	黄片 yellow ceramic	灰片 grey ceramic	黑片 black ceramic	倒喇叭型 Inverted horn	钢 Steel
3600	14.70-14.90	< 20	12500-14000	—	—		

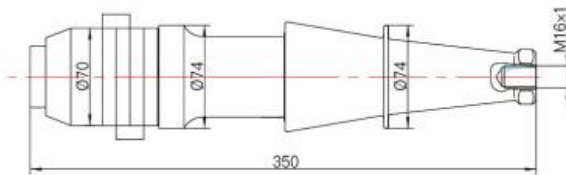

XT-6015-4Z-Z

功率 Power	频率范围 Frequency range	电阻范围 Resistance range	晶片颜色及电容范围 (pf) Capacitor range			换能器形状 Transducer shape	变幅杆材料 Material of booster
(W)	(kHz)	(Ω)	黄片 yellow ceramic	灰片 grey ceramic	黑片 black ceramic	柱型 Type column	钢 Steel
4200	14.70-14.90	< 20	18000-20000	20000-22000	—		

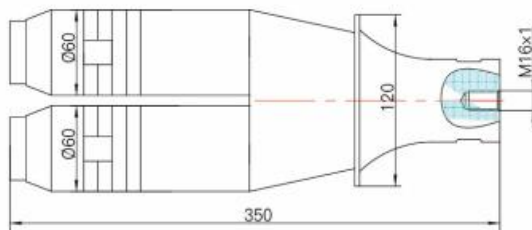



XT-5020-4CZ

功率 Power	频率范围 Frequency range	电阻范围 Resistance range	晶片颜色及电容范围 (pf) Capacitor range			换能器形状 Transducer shape	变幅杆材料 Material of booster
(W)	(kHz)	(Ω)	黄片 yellow ceramic	灰片 grey ceramic	黑片 black ceramic		
1500	19.70-20.00	< 20	11000-12000	13000-14000	14500-16000	长柱型 Long column	钢 Steel

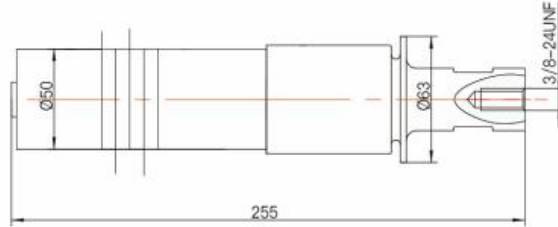

XT-5015-4D-Z

功率 Power	频率范围 Frequency range	电阻范围 Resistance range	晶片颜色及电容范围 (pf) Capacitor range			换能器形状 Transducer shape	变幅杆材料 Material of booster
(W)	(kHz)	(Ω)	黄片 yellow ceramic	灰片 grey ceramic	黑片 black ceramic		
3600	14.70-14.90	< 20	22000-24000	—	—	哑铃型 Type dumbbell	钢 Steel

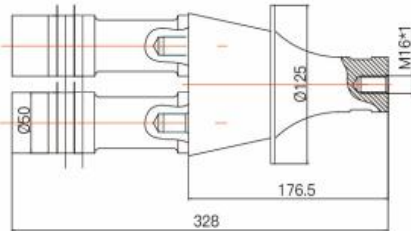

XT-4515-4D-Z

功率 Power	频率范围 Frequency range	电阻范围 Resistance range	晶片颜色及电容范围 (pf) Capacitor range			换能器形状 Transducer shape	变幅杆材料 Material of booster
(W)	(kHz)	(Ω)	黄片 yellow ceramic	灰片 grey ceramic	黑片 black ceramic		
2800	14.70-14.90	< 20	19000-21000	—	—	柱型 Type column	钢 Steel

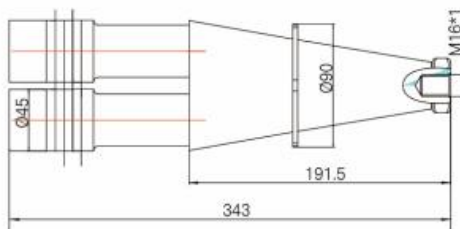



XT-4515-4Z-Z

功率 Power	频率范围 Frequency range	电阻范围 Resistance range	晶片颜色及电容范围 (pf) Capacitor range			换能器形状 Transducer shape	变幅杆材料 Material of booster
			黄片 yellow ceramic	灰片 grey ceramic	黑片 black ceramic		
2400	14.70-14.90	< 20	—	—	25000-27000	柱型 Type column	钢 Steel

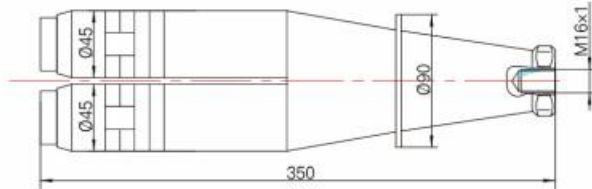

XT-5020-4Z

功率 Power	频率范围 Frequency range	电阻范围 Resistance range	晶片颜色及电容范围 (pf) Capacitor range			换能器形状 Transducer shape	变幅杆材料 Material of booster
			黄片 yellow ceramic	灰片 grey ceramic	黑片 black ceramic		
1500	19.70-20.00	< 20	11000-12000	13000-14000	14500-16000	柱型 Type column	钢 Steel



XT-5520-4Z-60

功率 Power	频率范围 Frequency range	电阻范围 Resistance range	晶片颜色及电容范围 (pf) Capacitor range			换能器形状 Transducer shape	变幅杆材料 Material of booster
			黄片 yellow ceramic	灰片 grey ceramic	黑片 black ceramic		
1800	19.70-20.00	< 20	10500-11500	—	—	柱型 Type column	钢 Steel

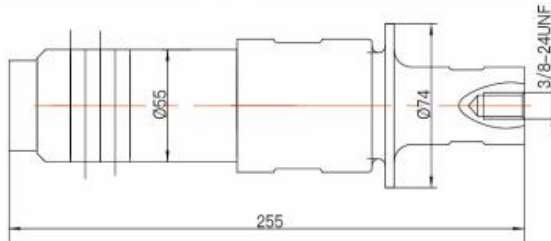



XT-5020-4ZC

功率 Power	频率范围 Frequency range	电阻范围 Resistance range	晶片颜色及电容范围 (pf) Capacitor range			换能器形状 Transducer shape	变幅杆材料 Material of booster
(W)	(kHz)	(Ω)	黄片 yellow ceramic	灰片 grey ceramic	黑片 black ceramic	柱型 Type column	钢 Steel
1500	19.70-20.00	< 20	11000-12000	13000-14000	14500-16000		

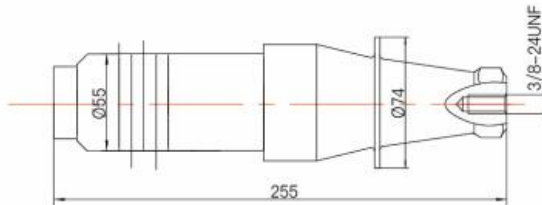

XT-5020-4ZZ

功率 Power	频率范围 Frequency range	电阻范围 Resistance range	晶片颜色及电容范围 (pf) Capacitor range			换能器形状 Transducer shape	变幅杆材料 Material of booster
(W)	(kHz)	(Ω)	黄片 yellow ceramic	灰片 grey ceramic	黑片 black ceramic	柱型 Type column	钢 Steel
1500	19.70-20.00	< 20	11000-12000	13000-14000	14500-16000		

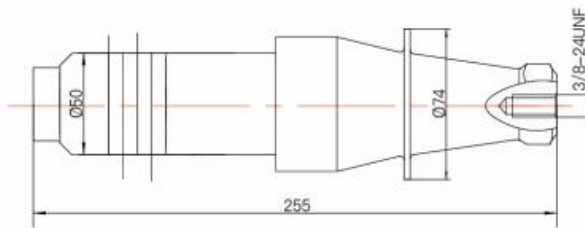

XT-3028-2T

功率 Power	频率范围 Frequency range	电阻范围 Resistance range	晶片颜色及电容范围 (pf) Capacitor range			换能器形状 Transducer shape	变幅杆材料 Material of booster
(W)	(kHz)	(Ω)	黄片 yellow ceramic	灰片 grey ceramic	黑片 black ceramic	柱型 Type column	钢 Steel
400	27.50-28.10	< 80	2800-3300	3300-3800	—		

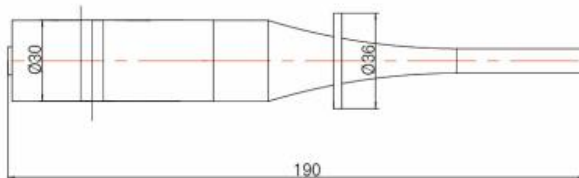



XT-3820-4Z-Z

功率 Power	频率范围 Frequency range	电阻范围 Resistance range	晶片颜色及电容范围 (pf) Capacitor range			换能器形状 Transducer shape	变幅杆材料 Material of booster
(W)	(kHz)	(Ω)	黄片 yellow ceramic	灰片 grey ceramic	黑片 black ceramic	柱型 Type column	钢 Steel
1800	19.70-20.00	< 15	13000-14500	—	—		

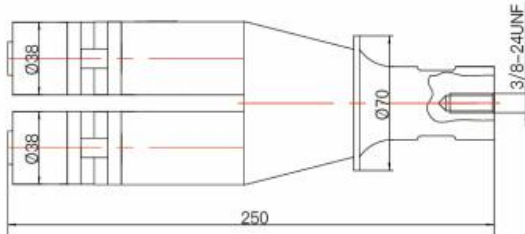

XT-6015-6D

功率 Power	频率范围 Frequency range	晶片颜色及电容范围 (pf) Capacitor range			换能器形状 Transducer shape
(W)	(kHz)	黄片 yellow ceramic	灰片 grey ceramic	黑片 black ceramic	倒喇叭型 Inverted horn
3600	14.50-15.10	19000-20500	20500-22500	—	

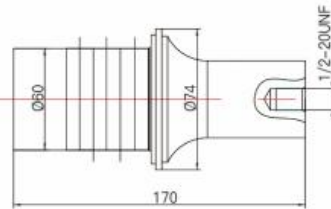

XT-6015-4D

功率 Power	频率范围 Frequency range	晶片颜色及电容范围 (pf) Capacitor range			换能器形状 Transducer shape
(W)	(kHz)	黄片 yellow ceramic	灰片 grey ceramic	黑片 black ceramic	倒喇叭型 Inverted horn
2600	14.50-15.10	9000-10000	10000-11000	12500-13500	

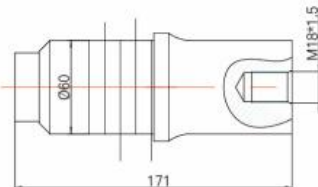



XT-6015-4D

功率 Power (W)	频率范围 Frequency range (kHz)	晶片颜色及电容范围 (pf) Capacitor range			换能器形状 Transducer shape
		黄片 yellow ceramic	灰片 grey ceramic	黑片 black ceramic	
2600	14.50-15.10	9000-10000	—	—	倒喇叭型 Inverted horn

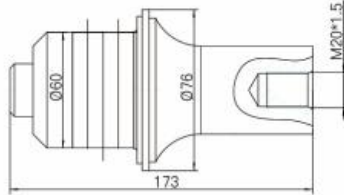

XT-7015-4D

功率 Power (W)	频率范围 Frequency range (kHz)	晶片颜色及电容范围 (pf) Capacitor range			换能器形状 Transducer shape
		黄片 yellow ceramic	灰片 grey ceramic	黑片 black ceramic	
3600	14.50-15.10	12500-14000	—	17000-19000	倒喇叭型 Inverted horn

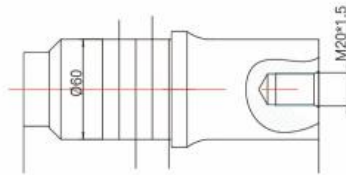

XT-5020-4CZ

功率 Power (W)	频率范围 Frequency range (kHz)	晶片颜色及电容范围 (pf) Capacitor range			换能器形状 Transducer shape
		黄片 yellow ceramic	灰片 grey ceramic	黑片 black ceramic	
1500	19.50-20.10	11000-12000	13000-14000	14500-16000	长柱型 Long column

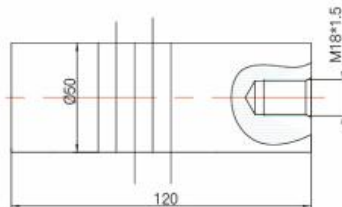

XT-5020-4Z



功率 Power (W)	频率范围 Frequency range (kHz)	晶片颜色及电容范围 (pf) Capacitor range			换能器形状 Transducer shape
		黄片 yellow ceramic	灰片 grey ceramic	黑片 black ceramic	
1500	19.50-20.10	11000-12000	13000-14000	14500-16000	柱型 Type column

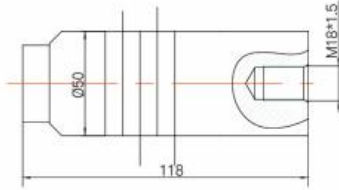

XT-5015-4IZ



功率 Power (W)	频率范围 Frequency range (kHz)	晶片颜色及电容范围 (pf) Capacitor range			换能器形状 Transducer shape
		黄片 yellow ceramic	灰片 grey ceramic	黑片 black ceramic	
1500	14.50-15.10	12000-13000	13000-14500	—	哑铃型 Type Dumbbell

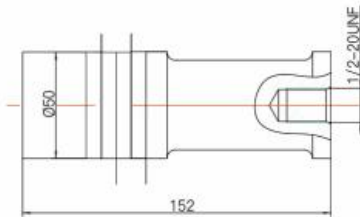

XT-5020-2GZ



功率 Power (W)	频率范围 Frequency range (kHz)	晶片颜色及电容范围 (pf) Capacitor range			换能器形状 Transducer shape
		黄片 yellow ceramic	灰片 grey ceramic	黑片 black ceramic	
800	19.50-20.10	—	5500-6100	—	中间夹铝型 The middle aluminum

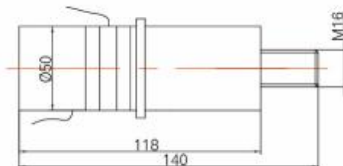

XT-5025-2Z



功率 Power (W)	频率范围 Frequency range (kHz)	晶片颜色及电容范围 (pf) Capacitor range			换能器形状 Transducer shape
		黄片 yellow ceramic	灰片 grey ceramic	黑片 black ceramic	
800	19.50-20.10	5500-6000	6500-7000	7300-8000	柱型 Type column

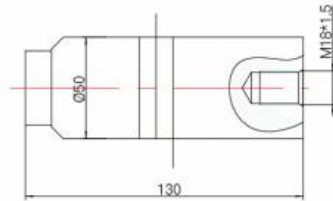

XT-5020-2HZ



功率 Power (W)	频率范围 Frequency range (kHz)	晶片颜色及电容范围 (pf) Capacitor range			换能器形状 Transducer shape
		黄片 yellow ceramic	灰片 grey ceramic	黑片 black ceramic	
800	19.50-20.10	5500-6200	—	—	钢后盖型 Steel rear cover

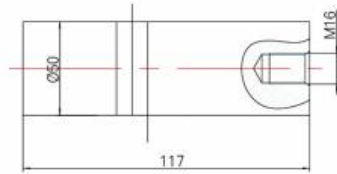

XT-5020-4ZH



功率 Power (W)	频率范围 Frequency range (kHz)	晶片颜色及电容范围 (pf) Capacitor range			换能器形状 Transducer shape
		黄片 yellow ceramic	灰片 grey ceramic	黑片 black ceramic	
1500	19.50-20.10	—	—	11000-12000	倒喇叭型 Inverted horn

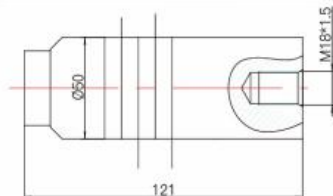



XT-3820-4ZH

功率 Power (W)	频率范围 Frequency range (kHz)	晶片颜色及电容范围 (pf) Capacitor range			换能器形状 Transducer shape
		黄片 yellow ceramic	灰片 grey ceramic	黑片 black ceramic	
800	19.50-20.10	6500-7500	—	—	柱型 Type column

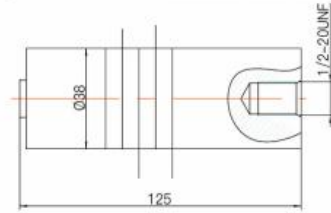

XT-5520-4Z

功率 Power (W)	频率范围 Frequency range (kHz)	晶片颜色及电容范围 (pf) Capacitor range			换能器形状 Transducer shape
		黄片 yellow ceramic	灰片 grey ceramic	黑片 black ceramic	
1800	19.50-20.10	10500-11500	—	—	柱型 Type column

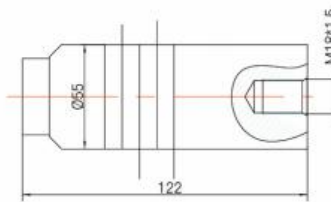

XT-5020-4D

功率 Power (W)	频率范围 Frequency range (kHz)	晶片颜色及电容范围 (pf) Capacitor range			换能器形状 Transducer shape
		黄片 yellow ceramic	灰片 grey ceramic	黑片 black ceramic	
1500	19.50-20.10	10500-12000	12500-14000	14500-16000	倒喇叭型 Inverted horn

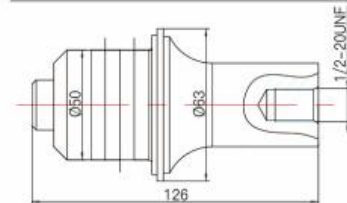

XT-4020-4D



功率 Power (W)	频率范围 Frequency range (kHz)	晶片颜色及电容范围 (pf) Capacitor range			换能器形状 Transducer shape
		黄片 yellow ceramic	灰片 grey ceramic	黑片 black ceramic	
900	19.50-20.10	7000-8000	8000-9000	10000-11000	倒喇叭型 Inverted horn

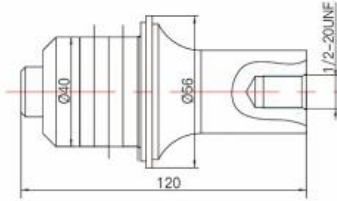

XT-5020-6D



功率 Power (W)	频率范围 Frequency range (kHz)	晶片颜色及电容范围 (pf) Capacitor range			换能器形状 Transducer shape
		黄片 yellow ceramic	灰片 grey ceramic	黑片 black ceramic	
2200	19.50-20.10	18000-20000	—	21000-23000	倒喇叭型 Inverted horn

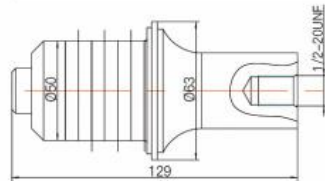

XT-3828-4Z



功率 Power (W)	频率范围 Frequency range (kHz)	晶片颜色及电容范围 (pf) Capacitor range			换能器形状 Transducer shape
		黄片 yellow ceramic	灰片 grey ceramic	黑片 black ceramic	
800	27.50-28.10	7200-8200	—	10000-12000	柱型 Type column

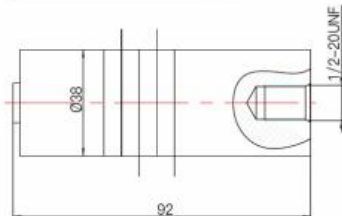

XT-3028-2FZ



功率 Power (W)	频率范围 Frequency range (kHz)	晶片颜色及电容范围 (pf) Capacitor range			换能器形状 Transducer shape 法兰柱型 Flange type
		黄片 yellow ceramic	灰片 grey ceramic	黑片 black ceramic	
400	27.50-28.10	2800-3300	3300-3800	—	

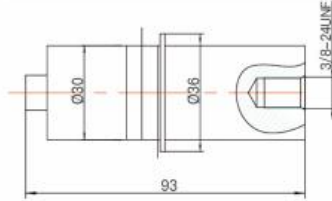

XT-2528-4FZ



功率 Power (W)	频率范围 Frequency range (kHz)	晶片颜色及电容范围 (pf) Capacitor range			换能器形状 Transducer shape 法兰柱型 Flange type
		黄片 yellow ceramic	灰片 grey ceramic	黑片 black ceramic	
500	27.50-28.10	3900-4300	—	—	

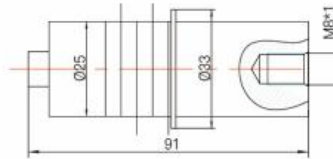

XT-2528-2FZ



功率 Power (W)	频率范围 Frequency range (kHz)	晶片颜色及电容范围 (pf) Capacitor range			换能器形状 Transducer shape 法兰柱型 Flange type
		黄片 yellow ceramic	灰片 grey ceramic	黑片 black ceramic	
300	27.50-28.10	1950-2300	2300-2600	—	

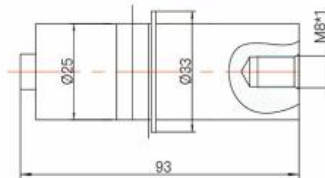



XT-3030-4ZH

功率 Power	频率范围 Frequency range	晶片颜色及电容范围 (pf) Capacitor range			换能器形状 Transducer shape
		黄片 yellow ceramic	灰片 grey ceramic	黑片 black ceramic	
(W)	(kHz)	—	6200-7200	—	柱型 Type column
700	29.50-30.10	—	6200-7200	—	柱型 Type column

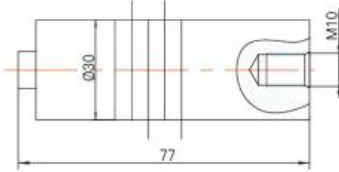

XT-3028-4FZ

功率 Power	频率范围 Frequency range	晶片颜色及电容范围 (pf) Capacitor range			换能器形状 Transducer shape
		黄片 yellow ceramic	灰片 grey ceramic	黑片 black ceramic	
(W)	(kHz)	—	6000-7000	—	法兰柱型 Flange type
700	27.50-28.10	—	6000-7000	—	法兰柱型 Flange type

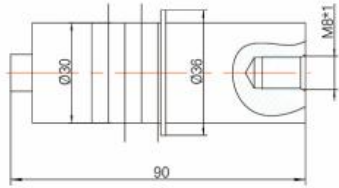

XT-3028-2Z

功率 Power	频率范围 Frequency range	晶片颜色及电容范围 (pf) Capacitor range			换能器形状 Transducer shape
		黄片 yellow ceramic	灰片 grey ceramic	黑片 black ceramic	
(W)	(kHz)	2800-3300	3300-3800	—	柱型 Type column
400	27.50-28.10	2800-3300	3300-3800	—	柱型 Type column

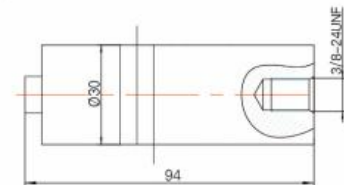

XT-3028-4ZH



功率 Power (W)	频率范围 Frequency range (kHz)	晶片颜色及电容范围 (pf) Capacitor range			换能器形状 Transducer shape
		黄片 yellow ceramic	灰片 grey ceramic	黑片 black ceramic	
700	27.50-28.10	—	6000-7000	—	柱型 Type column

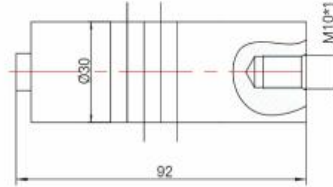

XT-3028-2Z



功率 Power (W)	频率范围 Frequency range (kHz)	晶片颜色及电容范围 (pf) Capacitor range			换能器形状 Transducer shape
		黄片 yellow ceramic	灰片 grey ceramic	黑片 black ceramic	
500	27.50-28.10	3700-4200	—	—	柱型 Type column

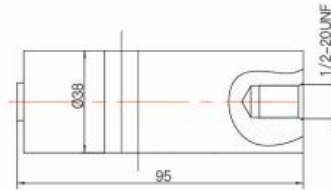

XT-2535-2FZ



功率 Power (W)	频率范围 Frequency range (kHz)	晶片颜色及电容范围 (pf) Capacitor range			换能器形状 Transducer shape
		黄片 yellow ceramic	灰片 grey ceramic	黑片 black ceramic	
300	34.50-35.10	1900-2050	2100-2600	—	法兰柱型 Flange type

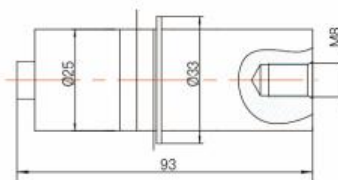

XT-2535-4LD

功率 Power	频率范围 Frequency range	晶片颜色及电容范围 (pf) Capacitor range			换能器形状 Transducer shape
		黄片 yellow ceramic	灰片 grey ceramic	黑片 black ceramic	
(W)	(kHz)				
500	34.50-35.10	3900-4600	—	—	螺纹法兰倒喇叭型 Screw flange type

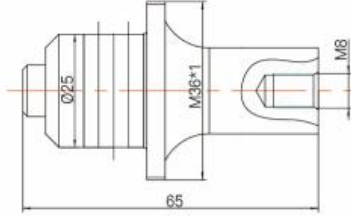

XT-2535-4DT

功率 Power	频率范围 Frequency range	晶片颜色及电容范围 (pf) Capacitor range			换能器形状 Transducer shape
		黄片 yellow ceramic	灰片 grey ceramic	黑片 black ceramic	
(W)	(kHz)				
500	34.50-35.10	—	6500-7500	—	裙边法兰倒喇叭型 Inverted flange type

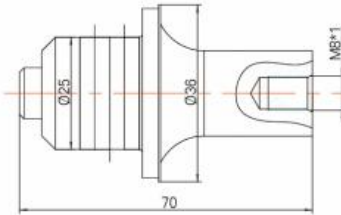

XT-3535-4D

功率 Power	频率范围 Frequency range	晶片颜色及电容范围 (pf) Capacitor range			换能器形状 Transducer shape
		黄片 yellow ceramic	灰片 grey ceramic	黑片 black ceramic	
(W)	(kHz)				
800	34.50-35.10	6600-7400	—	9000-10000	倒喇叭型 Inverted horn

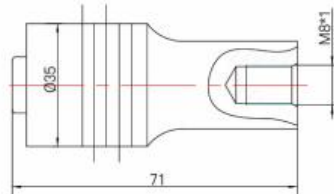

XT-3035-4Z



功率 Power (W)	频率范围 Frequency range (kHz)	晶片颜色及电容范围 (pf) Capacitor range			换能器形状 Transducer shape
		黄片 yellow ceramic	灰片 grey ceramic	黑片 black ceramic	
500	一体螺丝32.00-33.00	5500-6200	—	—	柱型 Type column

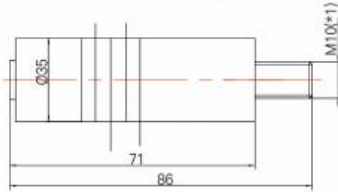

XT-2535-4FD



功率 Power (W)	频率范围 Frequency range (kHz)	晶片颜色及电容范围 (pf) Capacitor range			换能器形状 Transducer shape
		黄片 yellow ceramic	灰片 grey ceramic	黑片 black ceramic	
500	34.50-35.10	4500-5500	—	—	法兰倒喇叭型 Flange type reverse horn

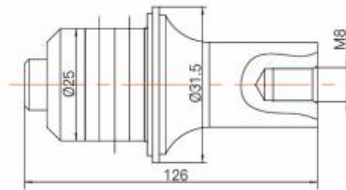

XT-5020-4WT



频率范围 Frequency range (kHz)	电容范围 Capacitor range (pf)	外壳直径 Shell diameter (mm)	螺孔尺寸 Screw size (mm)	代替型号 Substitute model
19.70-20.10	11000-12000	70/76	1/2-20UNF	DULANE 20KHz (Standard)

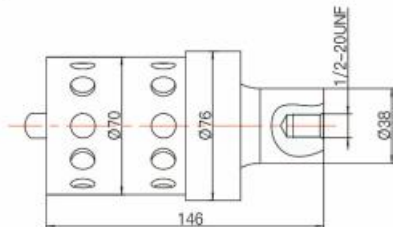



XT-5020-WTH

频率范围 Frequency range	电容范围 Capacitor range	外壳直径 Shell diameter	螺孔尺寸 Screw size	代替型号 Substitute model
(kHz)	(pf)	(mm)	(mm)	
19.70-20.10	11000-12000	70	1/2-20UNF	BRASON 402

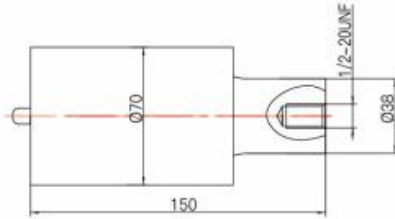

XT-5025-6WTH

频率范围 Frequency range	电容范围 Capacitor range	外壳直径 Shell diameter	螺孔尺寸 Screw size	代替型号 Substitute model
(kHz)	(pf)	(mm)	(mm)	
19.70-20.10	11000-12000	70	1/2-20UNF	BRASON 902

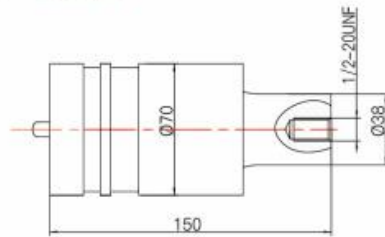

XT-2040-2D

功率 Power	频率范围 Frequency range	晶片颜色及电容范围 (pf) Capacitor range			换能器形状 Transducer shape
		黄片 yellow ceramic	灰片 grey ceramic	黑片 black ceramic	
(W)	(kHz)				
200	38.00-39.00	—	—	1500-1700	倒喇叭型 Inverted horn

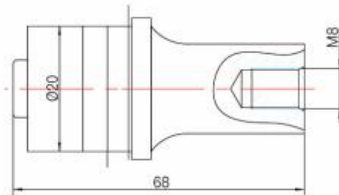



XT-2540-4FD

功率 Power (W)	频率范围 Frequency range (kHz)	晶片颜色及电容范围 (pf) Capacitor range			换能器形状 Transducer shape
		黄片 yellow ceramic	灰片 grey ceramic	黑片 black ceramic	
300	39.00-40.00	4500-5300	—	5500-6500	倒喇叭型 Inverted horn

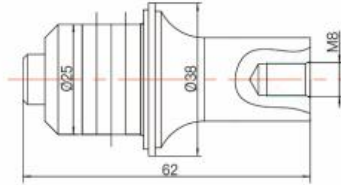

XT-3040-4Z

功率 Power (W)	频率范围 Frequency range (kHz)	晶片颜色及电容范围 (pf) Capacitor range			换能器形状 Transducer shape
		黄片 yellow ceramic	灰片 grey ceramic	黑片 black ceramic	
500	一体螺丝35.50-36.50	5100-5800	—	6500-7500	柱型 Type column

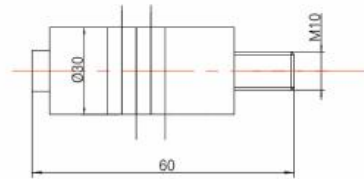

XT-3535-2D

功率 Power (W)	频率范围 Frequency range (kHz)	晶片颜色及电容范围 (pf) Capacitor range			换能器形状 Transducer shape
		黄片 yellow ceramic	灰片 grey ceramic	黑片 black ceramic	
500	34.50-35.10	4500-5000	—	—	倒喇叭型 Inverted horn

